



# Pro Modular Housing Solutions



**CON-101**

1404 Sq.ft.

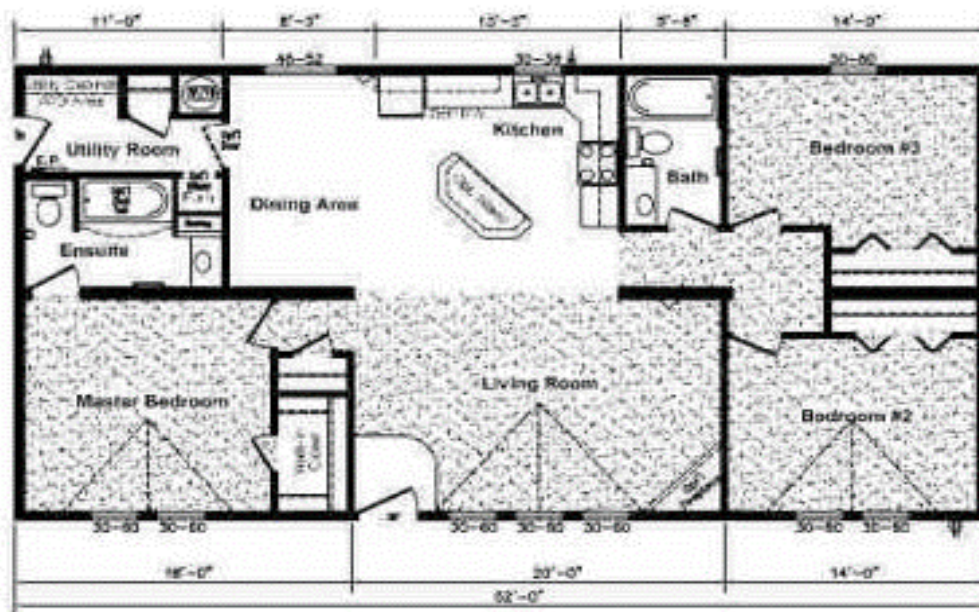

[www.promodularsolutions.com](http://www.promodularsolutions.com)

306-216-6261



# Pro Modular Housing **Solutions**

## *Concept Multi Module Standards*

### **Exterior:**

30-Year Architectural Fiberglass Shingles  
Engineered Roof Trusses  
Perimeter Eave & Continuous Ridge Venting  
Maintenance Free Full Vinyl Siding  
12" Residential Eaves  
Smart Start Around Windows  
8' Walls Ceilings  
2x6 Outside Walls at 16" O.C.  
3/8 OSB Sheathing on Inside & Outside of Exterior Walls  
2x8 Floor Joists (2x10 - 30' Wide's)  
Weatherproof Outside Receptacle Protected GFI (2)  
Frost Free Tap c/w Check Valve  
White Coach Lights at all Doors & on Front of Home  
White Metal Fascia

### **Interior:**

T&G OSB Floor Decking - Glued and Screwed  
R-40 Insulation in Ceiling  
R-20 Insulation in Walls  
R-26 Insulation in Floors  
6 Mil Poly Vapour Barrier in Ceilings & Sidewalls  
Spraytexed 1/2" SR Gyproc Ceilings  
Cathedral Ceiling in Living Room, Kitchen, and Dining Room  
100 % Nylon Carpet with Scotch guard Treatment in Living Room and All Bedrooms  
No Wax Vinyl Flooring  
Copper Wiring Throughout  
Utility Cabinets Above Washer & Dryer  
Wire Closet Shelving  
Pewter Hardware Package Throughout  
Upgraded Designer Drapery Package including Blinds on all Windows  
Trim Package #2  
Lever Door Handles Throughout

### **Kitchen:**

18 Cu Ft Two Door Frost Free Fridge - White  
30" Glass Door Electric Range - White  
Single Lever Faucet  
Double Stainless Steel Kitchen Sink  
Two Speed Range hood Vented to exterior  
Rolled Drawer Hardware

### **Bathrooms:**

GFI Receptacle in Bathroom  
Dehumidistat on Main Bath Fan  
Pressure Balanced Taps on Tubs(s)  
Single Lever Faucets  
White Bath Fixtures  
Shower Rod & Curtain in all Bathrooms  
Pewter Towel Bar and Paper Holder  
Shut-off Valves on All Fixtures

### **Doors:**

36" Steel Insulated Front Door c/w Peephole  
32" Steel Insulated Rear Door c/w Peephole  
Pre-Finished Interior Doors

### **Windows:**

White PVC "Low E" Windows with Screens  
30"x60" Standard Windows (Excluding Kitchen)  
30"x60" Standard Windows (Most Models)

### **Utilities:**

Smoke/CO Alarms w/ Battery Back Up in Hallway  
Smoke Alarms in All Bedrooms  
40 Gallon Natural GAS Water Heater  
Natural GAS High Efficiency Furnace c/w Electronic Ignition  
100 AMP Electric Service Panel  
Electric Conduit Through Floor  
Light Bulb Package  
Living Room Wired for Ceiling Fan c/w Separate Light Switch

