



Pro Modular Housing **Solutions**



DES-5-355

1674 Sq.ft.

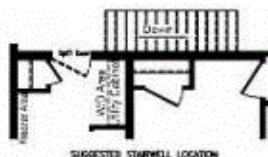
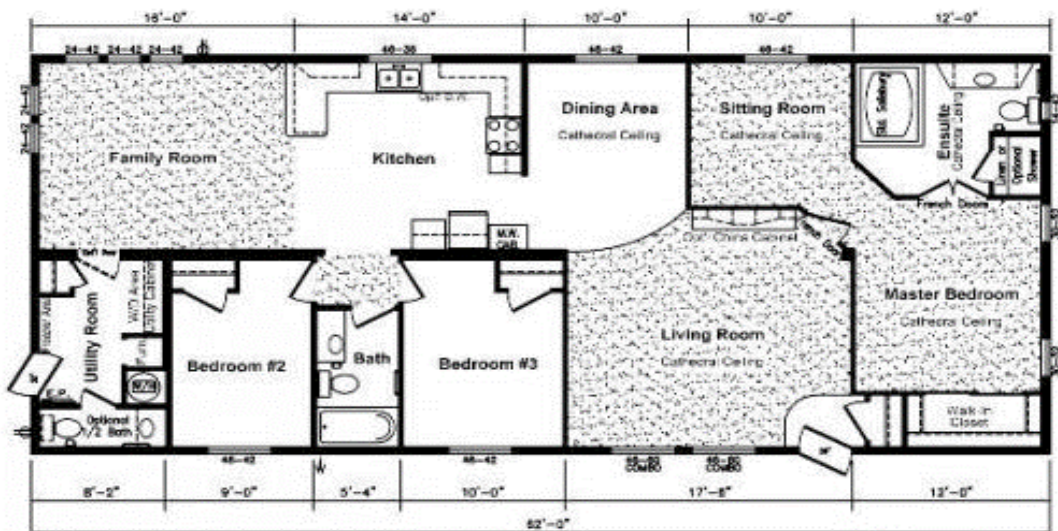

SUGGESTED STAIRWELL LOCATION



www.promodularsolutions.com

306-216-6261



Pro Modular Housing Solutions

Design 5 Multi Module Standards

Exterior:

30-Year Architectural Fiberglass Shingles
Engineered Roof Trusses
Perimeter Eave & Continuous Ridge Venting
Maintenance Free Full Vinyl Siding
12" Residential Eaves
Shutters on Door Side Windows
8' Walls Ceilings
2x6 Outside Walls at 16" O.C.
3/8 OSB Sheathing on Inside & Outside of
Exterior Walls
2x8 Floor Joists
Weatherproof Outside Receptacle Protected GFI (2)
Frost Free Tap c/w Check Valve
White Coach Lights at all Doors & on Front of Home
White Metal Fascia
Door Chimes at Both Exterior Doors

Interior:

T&G OSB Floor Decking - Glued and Screwed
R-40 Insulation in Ceiling
R-20 Insulation in Walls
R-26 Insulation in Floors
6 Mil Poly Vapour Barrier in Ceilings & Sidewalls
Spraytexed 1/2" SR Gyproc Ceilings
Cathedral Ceiling in Living Room, Kitchen, and
Dining Room
Polyurethane Carpet in Living Room and Mbedroom
No Wax Vinyl Flooring
Copper Wiring Throughout
Utility Cabinets Above Washer & Dryer
Wire Closet Shelving
Pewter Hardware Package Throughout
Upgraded Designer Drapery Package including
Blinds on all Windows
Trim Package #2
Lever Door Handles Throughout

Kitchen:

18 Cu Ft Two Door Frost Free Fridge - White
30" Glass Door Electric Range - White
Single Lever Faucet
Double Stainless Steel Kitchen Sink
Two Speed Range hood Vented to exterior
Rolled Drawer Hardware

Bathrooms:

GFI Receptacle in Bathroom
Dehumidistat on Main Bath Fan
One Piece Wall Tub/Shower in Main Bath
Pressure Balanced Taps on Tubs(s)
Single Lever Faucets
White Bath Fixtures
Shower Rod & Curtain in all Bathrooms
Pewter Towel Bar and Paper Holder
Shut-off Valves on All Fixtures

Doors:

36" Steel Insulated Front Door c/w Peephole
32" Steel Insulated Rear Door c/w Peephole
Pre-Finished Interior Doors
Aluminum Storm Doors

Windows:

White PVC "Low E" Windows with Screens

Utilities:

Smoke/CO Alarms w/Battery Back Up in Hallway
Smoke Alarms in All Bedrooms
40 Gallon Natural GAS Water Heater
Natural GAS High Efficiency Furnace c/w
Electronic Ignition
100 AMP Electric Service Panel
Electric Conduit Through Floor
Light Bulb Package
Living Room Wired for Ceiling Fan c/w
Separate Light Switch

