



# Pro Modular Housing **Solutions**



*\*Picture above may differ from the floor plan and Options listed on this brochure.*

## ***LME-009***

**1216 Sq.ft.**

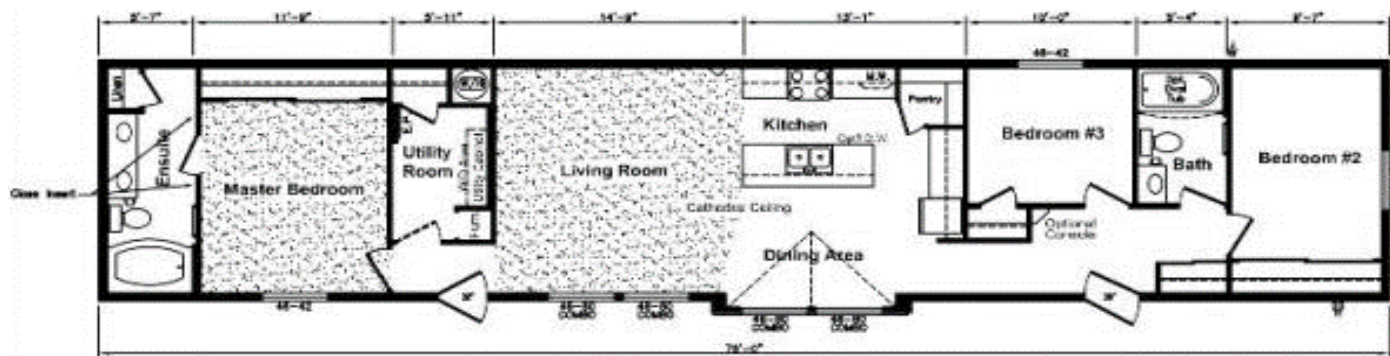

### ***Popular Options:***

*Deluxe Garden Door  
Frosted Pantry Door  
Ceramic Tile Backsplash  
Interior Utility Room Door*

*5' Shower with Glass Door  
6' Dormer  
Polyure Stone  
Shutters*



**[www.promodularsolutions.com](http://www.promodularsolutions.com)**

**306-216-6261**



# Pro Modular Housing **Solutions**

## *Limited Edition 16' Wide Standards*

### **Exterior:**

30-Year Architectural Fiberglass Shingles  
Engineered Roof Trusses  
Perimeter Eave & Continuous Ridge Venting  
Maintenance Free Full Vinyl Siding  
12" Residential Overhang on 3 Sides  
12' Dormer Over Living Room Window  
Smart Start Fascia, Corners & Pillars  
at Living Room Windows  
8' Walls Ceilings  
2x6 Outside Walls at 16" O.C.  
3/8 OSB Sheathing on Inside & Outside of  
Exterior Walls  
2x10 Floor Joists  
Weatherproof Outside Receptacle Protected w/GFI  
Frost Free Tap c/w Check Valve  
White Coach Lights at all Doors & on Front of Home

### **Interior:**

T&G OSB Floor Decking - Glued and Screwed  
R-40 Insulation in Ceiling  
R-20 Insulation in Walls  
R-26 Insulation in Floors  
6 Mil Poly Vapour Barrier in Ceilings & Sidewalls  
Spraytexed 1/2" SR Gyproc Ceilings  
Cathedral Ceiling in Living Room, Kitchen, Dining  
Room, Utility Room, MBedroom & En Suite  
Polyurethane Carpet in Living Room & MBedroom  
No Wax Vinyl Flooring  
Copper Wiring Throughout  
Utility Cabinets Above Washer & Dryer  
Wire Closet Shelving  
Pewter Hardware Package Throughout  
Designer Drapery Package including Blinds  
on all Windows  
Etched Mirror Plaque in Front Entry  
Microwave Shelf Built into Upper Kitchen Cabinets  
Corner Pantry  
Banjo Counter Tops in Both Baths (Per Floor Plan)  
Lever Door Handles Throughout  
Trim Package #2

### **Kitchen:**

18 Cu Ft Two Door Frost Free Fridge - White  
30" Glass Door Electric Range - White  
Dishwasher - White  
Double Stainless Steel Kitchen Sink  
Single Lever Faucet  
Two Speed Range hood Vented to exterior  
Cabinets with Framed Raised Panel Doors  
Rolled Drawer Hardware

### **Bathrooms:**

GFI Receptacle in Bathroom  
Dehumidistat on Main Bath Fan  
One Piece Wall Tub/Shower in Main Bath  
Jetted Oval wall Tub in En Suite Bath  
White Bath Fixtures  
Shower Rod & Curtain in all Bathrooms  
Pewter Towel Bar and Paper Holder  
Shut-off Valves on All Fixtures  
Framed Raised Panel Cabinet Doors

### **Doors:**

36" Steel Insulated Front Door c/w Peephole  
32" Steel Insulated Rear Door c/w Peephole  
Aluminum Storm Doors at Front & Rear Entry  
Pre-Finished Interior Doors

### **Windows:**

White PVC "Low E" Windows with Screens

### **Utilities:**

Smoke/CO Alarms with Battery Back Up in Hallway  
Smoke Alarms in All Bedrooms  
40 Gallon Natural GAS Water Heater  
Natural GAS High Efficiency Furnace c/w Electronic  
Ignition  
100 AMP Electric Service Panel  
Electric Conduit Through Floor  
Light Bulb Package  
Living Room Wired for Ceiling Fan c/w Separate  
Light Switch

