



# V.I. Modular Homes

 **Built Right**  **On Time**  **On Budget**

**NEW**



**DISPLAY  
HOME**

*\*Pictures above may differ from the floor plan on this brochure.*

## ***Fihuta***

**915 sqft**  
14' x 67'

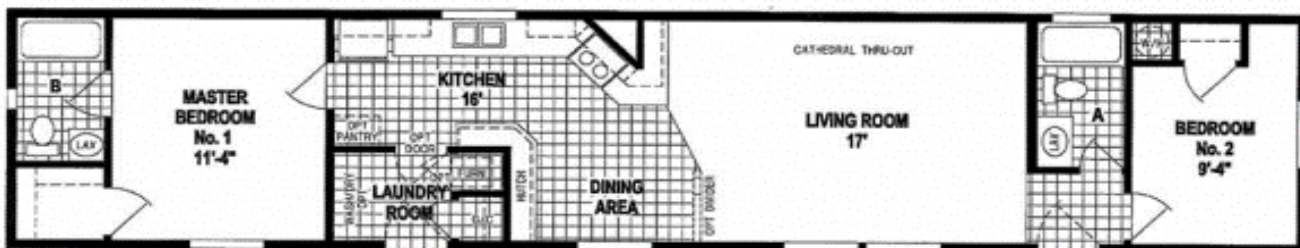

M731CTM/6714 (915 SQ. FT.) 2BEDROOM - 2BATHS - CATHEDRAL THROUGH-OUT  
M731MM/6714 (915 SQ. FT.) 2BEDROOM - 2BATHS - CATHEDRAL THROUGH-OUT

OPTION BAY

Display Shown with  
Box Bay Window



[www.vimodularhomes.com](http://www.vimodularhomes.com)

250-324-2288



# Key Features



**2 Bedroom Singlewide with spacious Living Room with Larger Windows. Gallery Style Kitchen with Optional Pantry Cabinets and Black Appliances.**

## **Interior**

Bright White Ceiling  
Smooth Wall finish IPO Standard  
White wood Window Sills  
Pocket Door in Master Bedroom Closet  
\*White 6-Panel Interior doors

## **Cabinets**

Extra Bank of Drawers in Kitchen  
False Front drawer tray at Sink in Kitchen  
\*Standard ~ Color: Ebusu  
Brushed Nickel Cabinet Knobs  
Cabinet Pantry in Kitchen  
Extra Shelf in upper Cabinets in Kitchen  
Glass Overhead Doors in Dining Room (1ea)

## **Appliances**

Upgraded Black Appliances (package #1)  
(Smooth Top Elec. Range, 22cuft SxS Refer, Dishwasher,  
and Microwave/Rangehood)

## **Bathroom**

Beveled Glass Medicine Cabinet (2ea)  
Wood Cabinet over Toilet (2ea)  
Banjo Lavy Top (2ea)  
60" Soaker Tub in ensuite  
Special Need Toilet (2ea)

## **Plumbing**

Extra Exterior Faucet (Total of 2)

## **Electrical**

Extra Phone & TV Jacks (2ea)  
Extra GFI (Total of 2)  
2ea Exterior Light  
\*Bedroom Ceiling Lights

## **Windows**

3ea 30x12 Transom windows in Living Room  
Box Bay Window with Shingle Shake Accent  
3ea 46x58 Windows IPO Std in Living & Dining Room  
Relocate of Std window in Living Room

## **Exterior**

\*Hardi CemPlank Vertical Siding ~ Color: Sawdust  
\*Trim ~ color: High Reflective White  
\*25 Year Shingles ~ Color: Driftwood

## **Exterior Doors**

9-light exterior doors (Front & Utility Room)

*\* Std Option with the Display Colors*



**www.vimodularhomes.com**

**250-324-2288**